

STANDARD NC BLOCKS

I Blocks

96-97

I Shape 3 Holes

96

I Shape 4 Holes

97

L-Blocks

98-100

L-Shaped 3 Holes

98

L-Shaped 4 Holes (Through)

99

L-Shaped 4 Holes (Tapped)

100

Rectangular Blocks

101-104

3 Holes

101

3 Holes Sideholes

102

4 Holes

103

4 Holes Sideholes

104



NC Blocks

STANDARD I SHAPED 3 HOLES



Standard NC Blocks

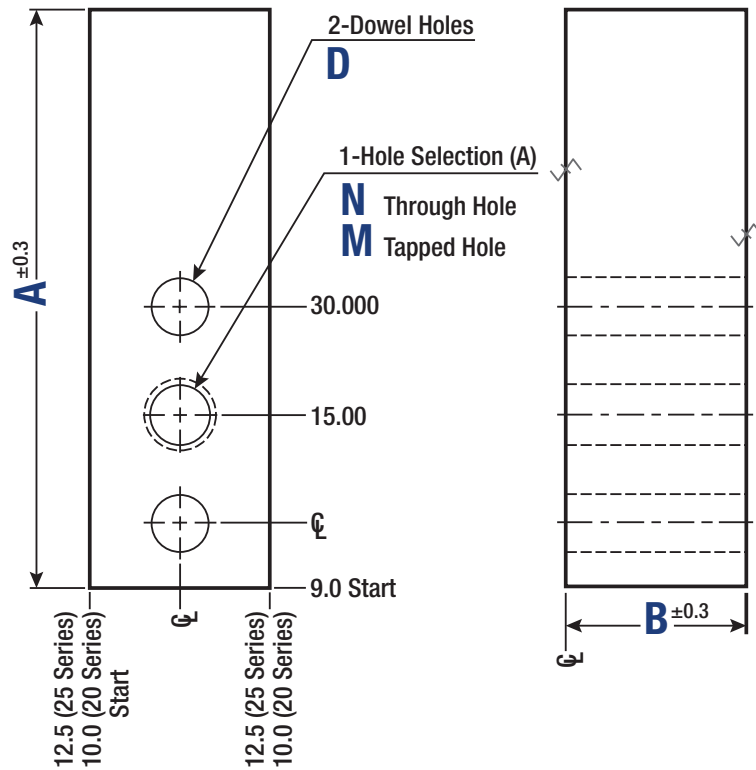

P/N Marking →

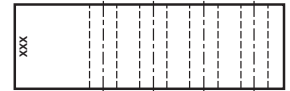

3D CAD is available online.

Type	Material	Coating
ANI	4140 Alloy Steel	Black Oxide
	304 Stainless Steel	—

Tolerance				
Dim.	Tol.	Finish (Ra)	Geometric	
0.0	±0.3	6.0 µm		0.015 T.I.R. Surfaces
0.00	±0.03	3.0 µm		
0.000	±0.02	1.6 µm		

Standard NAAMS (NC I-Shaped Block, 25 mm Series)

Type	Hole Selection (A) / Material				A Length	B Height	D Dowel Hole	
	M10		N11				Tolerance	
	4140	304	4140	304				
ANI	080	081	082	083	80.0	25.0	8F7	+0.013 / +0.028
	120	121	122	123	120.0			

M10 (M10 x 1.5 Tapped Hole), **N11** (Ø11 Through Hole). Standard NAAMS specifications are controlled by the NAAMS organization and the latest version of these products will be produced in compliance to: www.naamsstandards.org.

Standard NAAMS (NC I-Shaped Block, 20 mm Series)

Type	Hole Selection (A) / Material				A Length	B Height	D Dowel Hole	
	M8		N9				Tolerance	
	4140	304	4140	304				
ANI	206	207	208	209	80.0	20.0	8F7	+0.013 / +0.028
	216	217	218	219	120.0			

M8 (M8 x 1.25 Tapped Hole), **N9** (Ø9 Through Hole). Standard NAAMS specifications are controlled by the NAAMS organization and the latest version of these products will be produced in compliance to: www.naamsstandards.org.

P/N Example (Standard NAAMS):

Part Number	
Type	Specification
ANI	120
ANI	207



NC Blocks

STANDARD I SHAPED 4 HOLES

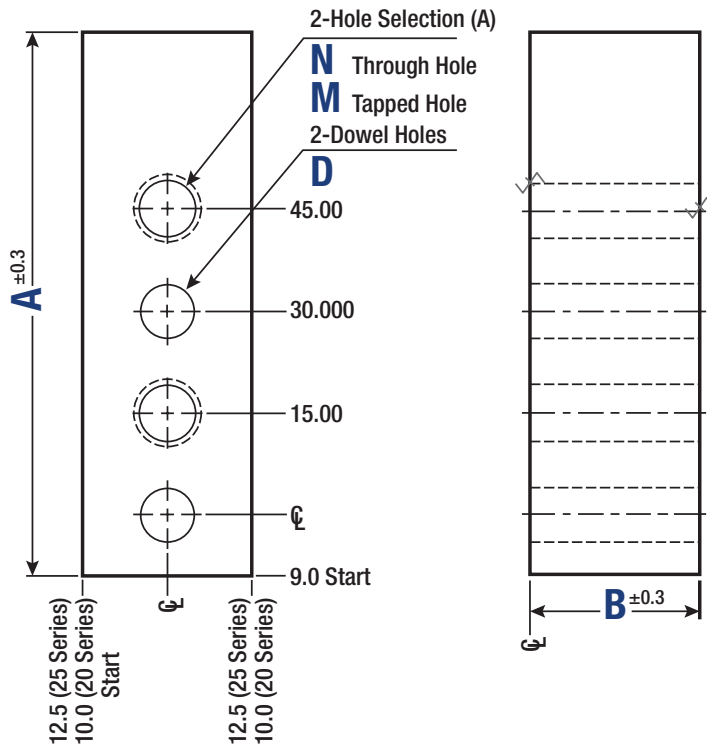

P/N Marking →



3D CAD is available online.

Type	Material	Coating
ANI	4140 Alloy Steel	Black Oxide
	304 Stainless Steel	—

Tolerance				
Dim.	Tol.	Finish (Ra)	Geometric	
0.0	±0.3	6.0 µm		0.015 T.I.R.
0.00	±0.03	3.0 µm		
0.000	±0.02	1.6 µm		

Standard NAAMS (NC I-Shaped Block, 25 mm Series)

Type	Hole Selection (A) / Material				A Length	B Height	D Dowel Hole	
	M10		N11				8F7	Tolerance
	4140	304	4140	304				
ANI	084	085	086	087	80.0	25.0	8F7	+0.013 / +0.028
	126	127	128	129	120.0			

M10 (M10 x 1.5 Tapped Hole), N11 (Ø11 Through Hole). Standard NAAMS specifications are controlled by the NAAMS organization and the latest version of these products will be produced in compliance to: www.naamsstandards.org.

Standard NAAMS (NC I-Shaped Block, 20 mm Series)

Type	Hole Selection (A) / Material				A Length	B Height	D Dowel Hole	
	M8		N9					Tolerance
	4140	304	4140	304				
ANI	201	202	203	204	80.0	20.0	8F7	+0.013 / +0.028
	384	385	386	387			6F7	+0.010 / +0.022
	211	212	213	214	120.0		8F7	+0.013 / +0.028
	426	427	428	429			6F7	+0.010 / +0.022

M8 (M8 x 1.25 Tapped Hole), N9 (Ø9 Through Hole). Standard NAAMS specifications are controlled by the NAAMS organization and the latest version of these products will be produced in compliance to: www.naamsstandards.org.

P/N Example (Standard NAAMS):

Part Number	
Type	Specification
ANI	126
ANI	201

NC Blocks

STANDARD L-SHAPED 3 HOLES

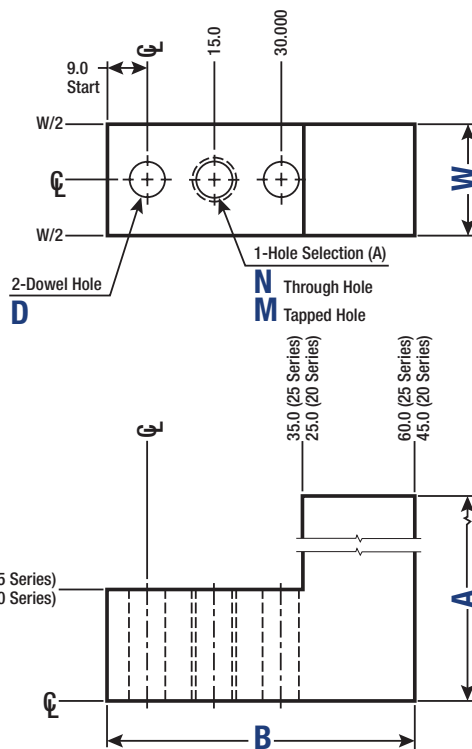

3D CAD is available online.

Type	Material	Coating
ANL	4140 Alloy Steel	Black Oxide
	304 Stainless Steel	—

Tolerance					
Dim.	Tol.	Finish (Ra)	Geometric		
0.0	±0.3	6.0 μm			0.015 T.I.R.
0.00	±0.03	3.0 μm			
0.000	±0.02	1.6 μm			

Standard NAAMS (NC L-Block, 25 mm Series)									
Type	Hole Selection (A) / Material				A	B	W	D Dowel Hole	
	M10		N11						
	4140	304	4140	304					
ANL	060	061	062	063	60.0	69.0	25.0	8 F7	+0.013 / +0.028
	100	101	102	103	100.0				

M10 (M10 x 1.5 Tapped Hole), **N11** (Ø11 Through Hole). Standard NAAMS specifications are controlled by the NAAMS organization and the latest version of these products will be produced in compliance to: www.naamsstandards.org.

Standard NAAMS (NC L-Block, 20 mm Series)									
Type	Hole Selection (A) / Material				A	B	W	D Dowel Hole	
	M8		N9						
	4140	304	4140	304				Tolerance	
ANL	215	216	217	218	60.0	54.0	20.0	8F7	+0.013 / +0.028
	225	226	227	228	100.0				

M8 (M8 x 1.25 Tapped Hole), **N9** (Ø9 Through Hole). Standard NAAMS specifications are controlled by the NAAMS organization and the latest version of these products will be produced in compliance to: www.naamsstandards.org.

P/N Example (Standard NAAMS):

Part Number	
Type	Specification
ANL	061
ANL	102



NC Blocks

STANDARD L-SHAPED 4 HOLES (THROUGH)

3D CAD is available online.

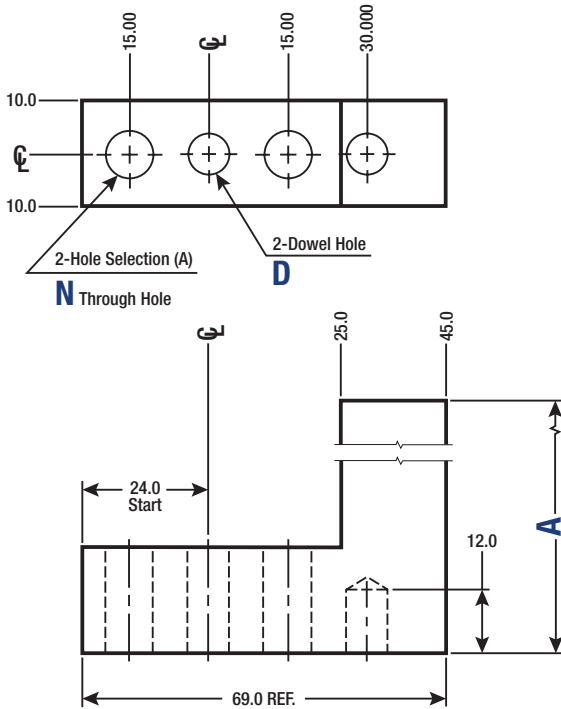

Type	Material	Coating
ANL	4140 Alloy Steel	Black Oxide
	304 Stainless Steel	—

Tolerance					
Dim.	Tol.	Finish (Ra)	Geometric		
0.0	±0.3	6.0 µm			0.015 T.I.R.
0.00	±0.03	3.0 µm			
0.000	±0.02	1.6 µm			

Standard NAAMS (NC-L Block, 20 mm Series)					
Type	Hole Selection (A) / Material		A	D Dowel Hole	
	4140	304			Tolerance
ANL	221	222	60.0	8 F7	+0.013 ~ +0.028
	366	367		6 F7	+0.010 ~ +0.022
	406	407	100.0	6 F7	+0.010 ~ +0.022
	411	412		8 F7	+0.013 ~ +0.028

P/N Example (Standard NAAMS):	
Part Number	
Type	Specification
ANL	407

N9 (Ø9 Through Hole). Standard NAAMS specifications are controlled by the NAAMS organization and the latest version of these products will be produced in compliance to: www.naamsstandards.org.



NC Blocks

STANDARD L-SHAPE 4 HOLE TYPE (25MM SERIES, THROUGH & DOWEL)

3D CAD is available online.

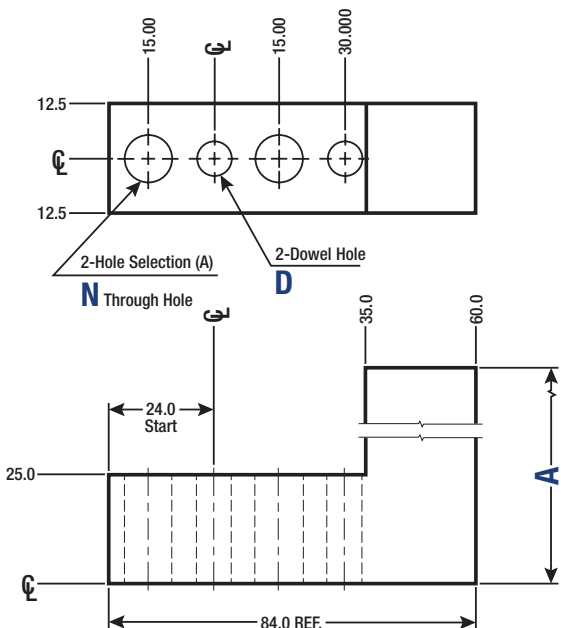

Type	Material	Coating
ANL	4140 Alloy Steel	Black Oxide
	304 Stainless Steel	—

Tolerance					
Dim.	Tol.	Finish (Ra)	Geometric		
0.0	±0.3	6.0 µm			0.015 T.I.R.
0.00	±0.03	3.0 µm			
0.000	±0.02	1.6 µm			

Standard NAAMS (25 Series NC L-Block)					
Type	Hole Selection (A) / Material		A Length	D Dowel Hole	
	4140	304			Tolerance
ANL	066	067	60.0	8 F7	+0.013 / +0.028
	106	107	100.0		

P/N Example (Standard NAAMS):	
Part Number	
Type	Specification
ANL	106

N11 (Ø11 Through Hole). Standard NAAMS specifications are controlled by the NAAMS organization and the latest version of these products will be produced in compliance to: www.naamsstandards.org.

NC Blocks

STANDARD L-SHAPED 4 HOLES (TAPPED)



3D CAD is available online.

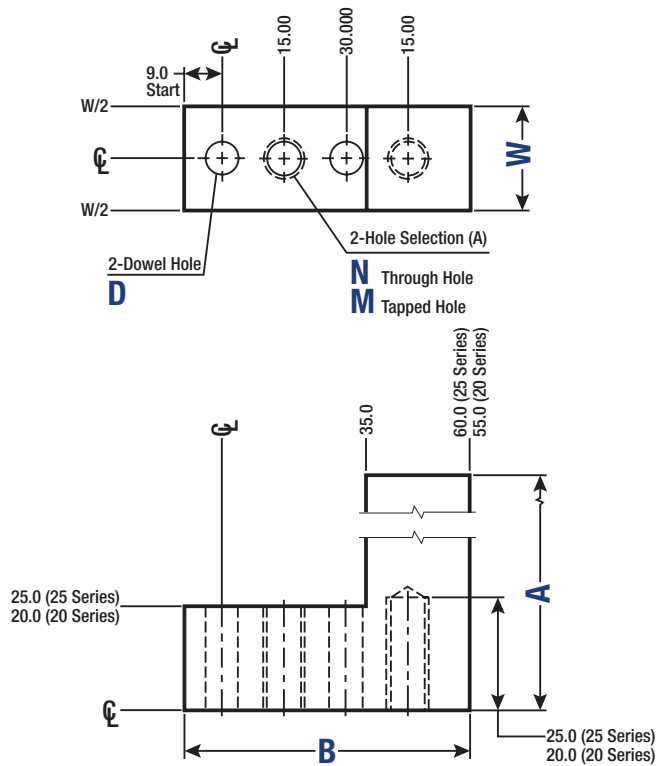

Type	Material	Coating
ANL	4140 Alloy Steel	Black Oxide
	304 Stainless Steel	—

Tolerance				
Dim.	Tol.	Finish (Ra)	Geometric	
0.0	±0.3	6.0 µm		0.015 T.I.R.
0.00	±0.03	3.0 µm		
0.000	±0.02	1.6 µm		

Standard NAAMS (NC L-Block, 25 mm Series)							
Type	Hole Selection (A) / Material		A	B	W		D Dowel Hole
	M10						
	4140	304					Tolerance
ANL	064	065	60.0	69.0	25.0	8F7	+0.013 / +0.028
	104	105	100.0				

M10 (M10 x 1.5 Tapped Hole). Standard NAAMS specifications are controlled by the NAAMS organization and the latest version of these products will be produced in compliance to: www.naamsstandards.org.

Standard NAAMS (NC L-Block, 20 mm Series)							
Type	Hole Selection (A) / Material		A	B	W	D Dowel Hole	
	M8					Tolerance	
	4140	304					
ANL	211	212	60.0	64.0	20.0	8 F7	+0.013 / +0.028
	311	312	100.0				
	364	365	60.0			6 F7	+0.010 / +0.022
	404	405	100.0				

M8 (M8 x 1.25 Tapped Hole). Standard NAAMS specifications are controlled by the NAAMS organization and the latest version of these products will be produced in compliance to: www.naamsstandards.org.

P/N Example (Standard NAAMS):	
Part Number	
Type	Specification
ANL	105



NC Blocks

STANDARD RECTANGULAR SHAPED 3 HOLES

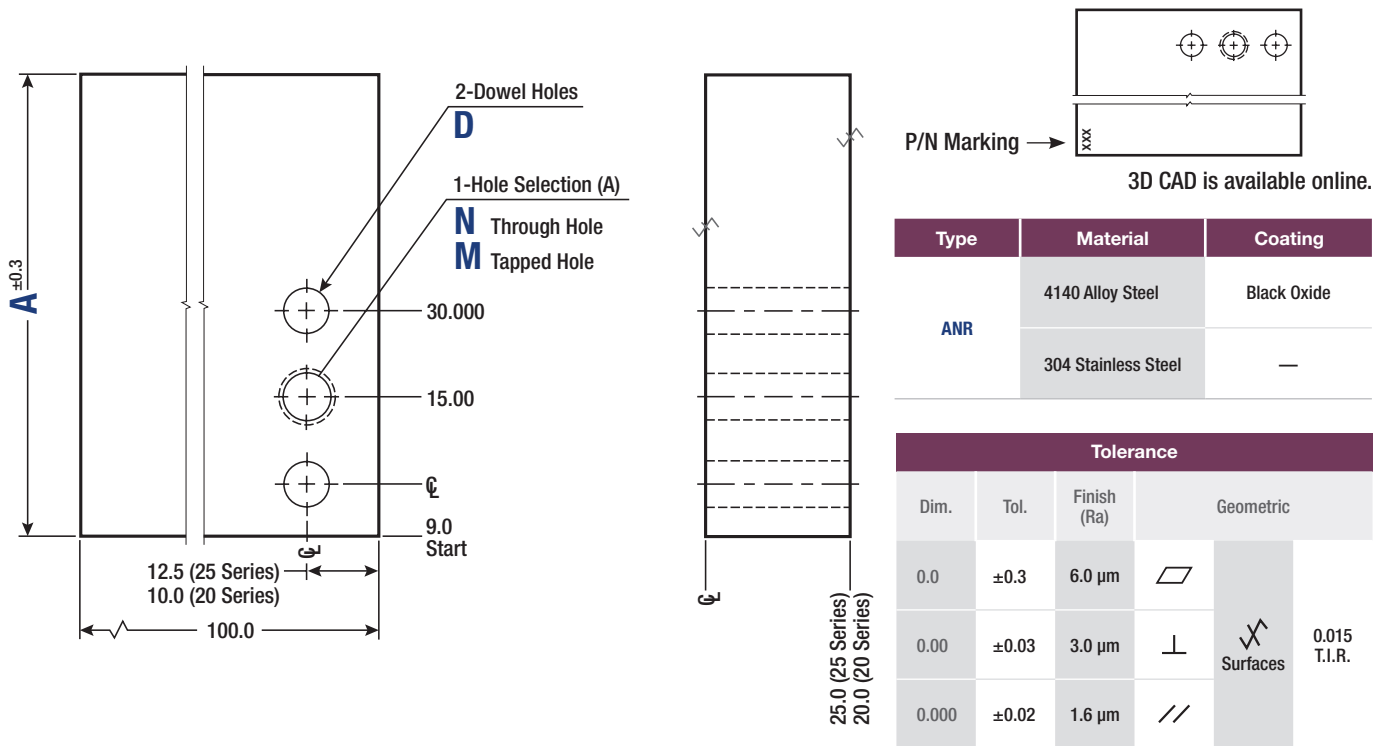

Standard NC Blocks

Standard NAAMS (NC Rectangular Block, 25 mm Series)							
Type	Hole Selection (A) / Material				A Length	D Dowel Hole	
	M10		N11			8F7	Tolerance
	4140	304	4140	304			
ANR	130	131	132	133	80.0	8F7	+0.013 / +0.028
	134	135	136	137	120.0		

M10 (M10 x 1.5 Tapped Hole), **N11** (Ø11 Through Hole). Standard NAAMS specifications are controlled by the NAAMS organization and the latest version of these products will be produced in compliance to: www.naamsstandards.org.

Standard NAAMS (NC Rectangular Block, 20 mm Series)							
Type	Hole Selection (A) / Material				A Length	D Dowel Hole	
	M8		N9				
	4140	304	4140	304			Tolerance
ANR	600	601	602	603	80.0	8F7	+0.013 / +0.028
	604	605	606	607	120.0		

M8 (M8 x 1.25 Tapped Hole), **N9** (Ø9 Through Hole). Standard NAAMS specifications are controlled by the NAAMS organization and the latest version of these products will be produced in compliance to: www.naamsstandards.org.

P/N Example (Standard NAAMS):	
Part Number	
Type	Specification
ANR	130
ANR	320

NC Blocks

STANDARD RECTANGULAR SHAPED 3 HOLES SIDEHOLES

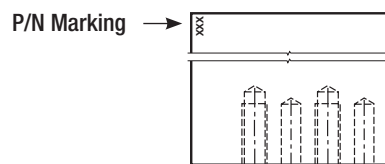
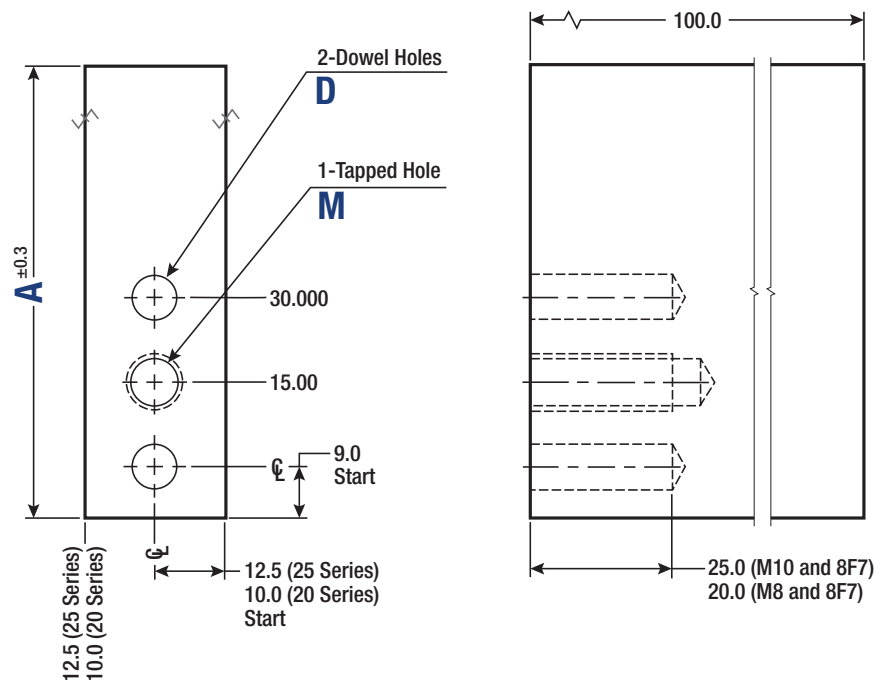

3D CAD is available online.

Type	Material	Coating
ANR	4140 Alloy Steel	Black Oxide
	304 Stainless Steel	—

Tolerance					
Dim.	Tol.	Finish (Ra)	Geometric		
0.0	±0.3	6.0 µm			0.015 T.I.R.
0.00	±0.03	3.0 µm			
0.000	±0.02	1.6 µm			

Standard NAAMS (25 mm Series, NC Rectangular Block)

Type	Tapped Hole / Material		A Length	D Dowel Hole	
	M10			Tolerance	
	4140	304			
ANR	230	231	80.0	8F7	+0.013 / +0.028
	232	233	120.0		

M10 (M10 x 1.5 Tapped Hole). Standard NAAMS specifications are controlled by the NAAMS organization and the latest version of these products will be produced in compliance to: www.naamsstandards.org.

Standard NAAMS (20 mm Series, NC Rectangular Block)

Type	Tapped Hole / Material		A Length	D Dowel Hole	
	M8			Tolerance	
	4140	304			
ANR	320	321	80.0	8F7	+0.013 / +0.028
	322	323	120.0		

M8 (M8 x 1.25 Tapped Hole). Standard NAAMS specifications are controlled by the NAAMS organization and the latest version of these products will be produced in compliance to: www.naamsstandards.org.

P/N Example (Standard NAAMS):

Part Number	
Type	Specification
ANR	230
ANR	321



NC Blocks

STANDARD RECTANGULAR SHAPED 4 HOLES

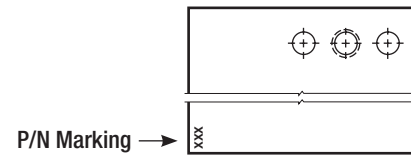
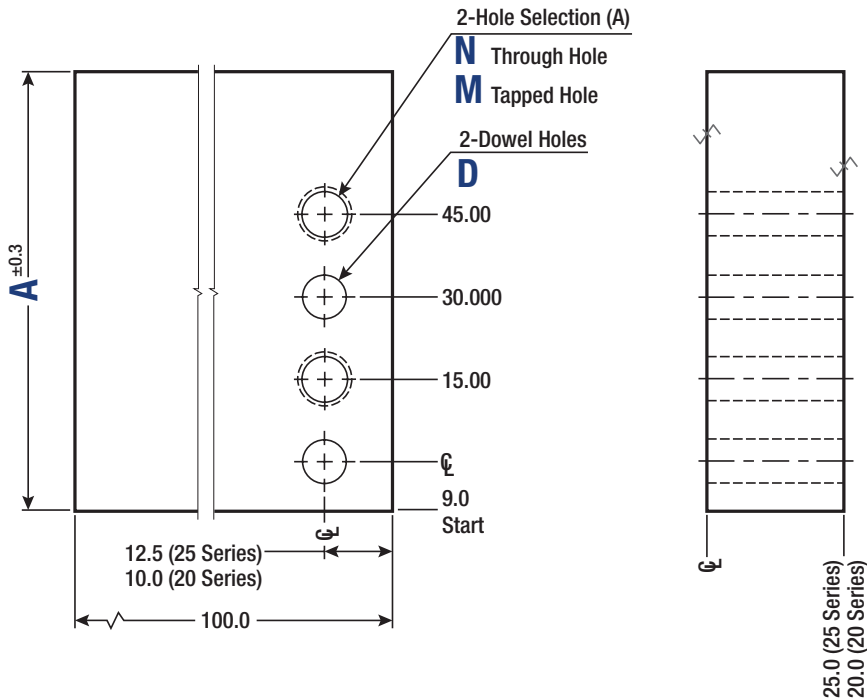

3D CAD is available online.

Type	Material	Coating
ANR	4140 Alloy Steel	Black Oxide
	304 Stainless Steel	—

Tolerance				
Dim.	Tol.	Finish (Ra)	Geometric	
0.0	±0.3	6.0 µm		0.015 T.I.R.
0.00	±0.03	3.0 µm		
0.000	±0.02	1.6 µm		

Standard NAAMS (NC Rectangular Block, 25 mm Series)							
Type	Hole Selection (A) / Material				A Length	D Dowel Hole	
	M10		N11				
	4140	304	4140	304			Tolerance
ANR	140	141	142	143	80.0	8F7	+0.013 / +0.028
	144	145	146	147	120.0		

M10 (M10 x 1.5 Tapped Hole), **N11** (Ø11 Through Hole). Standard NAAMS specifications are controlled by the NAAMS organization and the latest version of these products will be produced in compliance to: www.naamsstandards.org.

Standard NAAMS (NC Rectangular Block, 20 mm Series)							
Type	Hole Selection (A) / Material				A Length	D Dowel Hole	
	M8		N9				
	4140	304	4140	304			Tolerance
ANR	440	441	442	443	80.0	6F7	+0.010 / +0.022
	444	445	446	447	120.0		
	301	302	303	304	80.0	8F7	+0.013 / +0.028
	305	306	307	308	120.0		

M8 (M8 x 1.25 Tapped Hole), **N9** (Ø9 Through Hole). Standard NAAMS specifications are controlled by the NAAMS organization and the latest version of these products will be produced in compliance to: www.naamsstandards.org.

P/N Example (Standard NAAMS):	
Part Number	
Type	Specification
ANR	140
ANR	440

NC Blocks

STANDARD RECTANGULAR SHAPED 4 HOLES SIDEHOLES

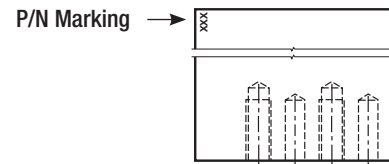
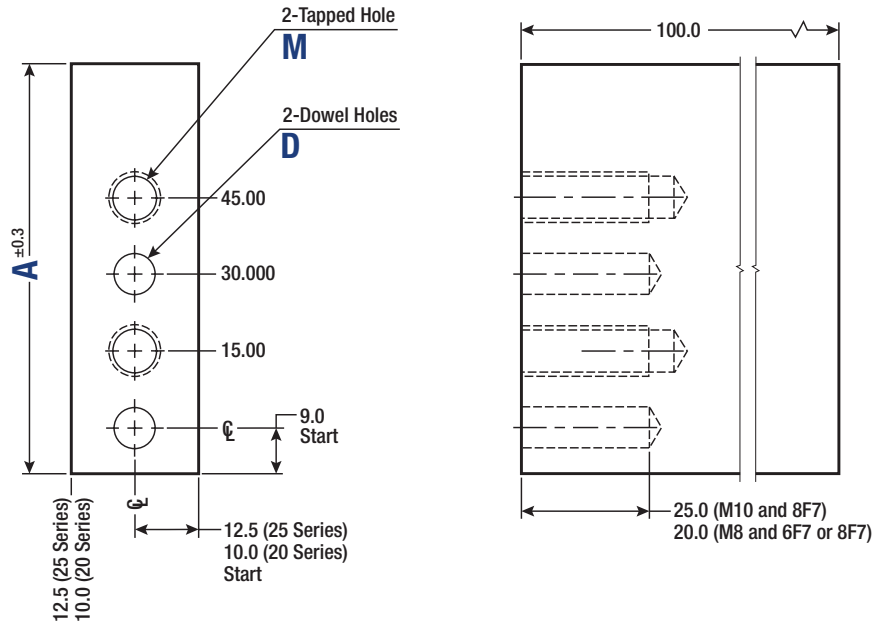

3D CAD is available online.

Type	Material	Coating
ANR	4140 Alloy Steel	Black Oxide
	304 Stainless Steel	—

Tolerance					
Dim.	Tol.	Finish (Ra)	Geometric		
0.0	±0.3	6.0 µm	Surfaces	0.015 T.I.R.	
0.00	±0.03	3.0 µm			
0.000	±0.02	1.6 µm			

Standard NAAMS (NC Rectangular Block, 25 mm Series)					
Type	Tapped Hole / Material		A Length	D Dowel Hole	
	M10			Tolerance	
	4140	304			
ANR	240	241	80.0	8F7	+0.013 / +0.028
	242	243	120.0		

M10 (M10 x 1.5 Tapped Hole). Standard NAAMS specifications are controlled by the NAAMS organization and the latest version of these products will be produced in compliance to: www.naamsstandards.org.

Standard NAAMS (NC Rectangular Block, 20 mm Series)					
Type	Tapped Hole / Material		A Length	D Dowel Hole	
	M8			Tolerance	
	4140	304			
ANR	540	541	80.0	6F7	+0.010 / +0.022
	542	543	120.0		
	311	312	80.0	8F7	+0.013 / +0.028
	313	314	120.0		

M8 (M8 x 1.25 Tapped Hole). Standard NAAMS specifications are controlled by the NAAMS organization and the latest version of these products will be produced in compliance to: www.naamsstandards.org.

P/N Example (Standard NAAMS):	
Part Number	
Type	Specification
ANR	240
ANR	540